



PRO GRIPTM

IT NEVER LETS GO

BASECOAT

TECHNICAL DATA SHEET

PURPOSE

PRO GRIP BASECOAT® is a specially formulated cement-based compound designed to be used in combination with **PRO GRIP KEYCOAT** for surface preparation prior to the installation of tiles. With its superior adhesion properties, the resultant slurry bonds well to all types of surfaces and dries to form water resistant surface suitable for tiling.

RECOMMENDED FOR

- a) Smooth dense surfaces **e.g.** powerfloated screeds
- b) Excessively porous surfaces **e.g.** concrete bricks
- c) Nonporous surfaces **e.g.** steel
- d) Flexible surfaces **e.g.** wood, gypsum board
- e) Previously coated surfaces

BENEFITS & FEATURES

- a) Superior adhesion properties
- b) Improved workability and ease of use
- c) Water resistant

 **SUSTAINABLE DEVELOPMENT GOALS**



BASECOAT

TECHNICAL DATA SHEET

**PRO
GRIP**[®]
IT NEVER LETS GO

MIXING INSTRUCTIONS

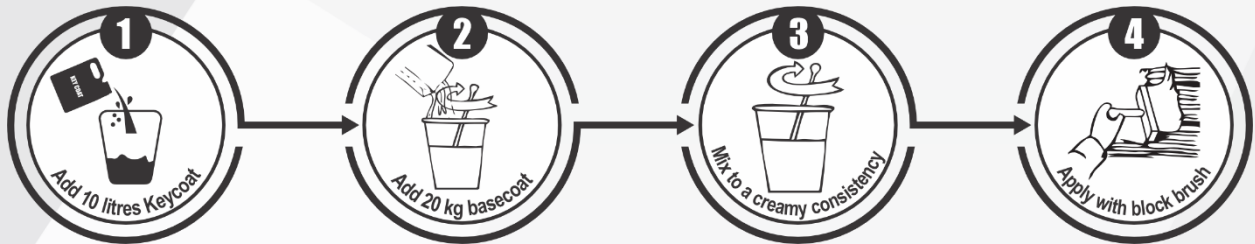

- Wear appropriate safety gear before mixing (see MSDS for details).
- The mixing ratios are as follows:**
 - 10 Lt of Pro Grip Keycoat to **20 Kg** of Pro Grip Basecoat.
 - 2.5 Lt of Pro Grip Keycoat to **5 Kg** of Pro Grip Basecoat.
- Add the Pro Grip Keycoat into suitably size container.
- Slowly add the basecoat while mixing. The use of an electric drill & paddle at low speed is recommended.
- Continue mixing until a smooth lump free consistency is achieved.
- Let the mixture stand for 2 mins to ensure the chemical additives are fully dissolved. Remix for 30 sec before using.
- Remix if the mixture becomes heavy or stiff. Do not add extra water. Use within 3 hours.

SURFACE PREPARATION

Please ensure the installation is performed in strict accordance with SANS 10107:2011, The design and installation of ceramic tiling.

- All surfaces to be tiled should be dry, level, clean and free of dust.
- Surface contaminates (release agents or laitance) should be removed with a mild acid wash followed by neutralizing and rinse wash. **Pro Care Grout Remover** and **Pro Care Heavy Duty Cleaner** are recommended. Organic fouling (fungi, algae) may be removed by washing with a strong bleach solution or **Pro Care Mould Remover**.

*This guideline only serves as a basic manual for the surface preparation, product selection and installation procedure for this type of application. Each installation needs to be assessed on merits and the products used and the procedures followed should be in accordance with the SABS code for the design and installation of ceramic tiles (SABS 10107:2011).



BASECOAT

TECHNICAL DATA SHEET



- c. Newly constructed surfaces must be fully cured and settled. Wait the following periods before tiling.

New concrete or brick surfaces	6 weeks
Newly plastered wall	2 weeks
Newly screeded floors:	4 weeks

PRODUCT APPLICATION

- a. Apply a thin 1 – 2 mm coat of adhesive with a flat side of the trowel. Press firmly to key the adhesive to the substrate.
- b. Apply additional mortar with the notched side of the trowel, combing in one direction. Ensure a minimum adhesive bed height of 6 – 7 mm for floor tiling and 3 – 4 mm for wall tiling.
- c. Only apply adhesive to an area that can be tiled within 10 min.
- d. Bed the tiles firmly into the adhesive bed to ensure maximum contact between the adhesive and tile. Remove excess adhesive from the joints.
- e. Choose the correct sized notched trowel - see below:

Application	Trowel Size (height x width x gap)
Wall tiles	6mm x 8mm x 5mm
Floor tiles smaller than 400mm x 400mm	10mm x 10mm x 6mm
Floor tiles larger than 400mm x 400mm	17mm x 22mm x 6mm

*This guideline only serves as a basic manual for the surface preparation, product selection and installation procedure for this type of application. Each installation needs to be assessed on merits and the products used and the procedures followed should be in accordance with the SABS code for the design and installation of ceramic tiles (SABS 10107:2011).



BASECOAT

TECHNICAL DATA SHEET

**PRO
GRIP**[®]
IT NEVER LETS GO

EXPANSION JOINTS

- a. Perimeter expansion joints should be installed on all tiled surfaces – walls and floors.
- b. Perimeter expansion joints should also be installed around any columns, staircases, windows, and any other projecting components.
- c. These joints should be left empty and covered with skirting boards or if exposed, filled with a bond breaker and flexible Polyurethane sealant like **Pro Grip Expansion Joint Sealant**.
- d. Intermediate expansion joints should be installed when the tiling span is longer than 5m on surface bed applications or 3m on suspended surfaces. Intermediate expansion joints should be installed over any structural expansion joints in the substrate. Fill with a bond breaker and a suitable Polyurethane sealant like **Pro Grip Expansion Joint Sealant**.
- e. Movement joints must be incorporated at more frequent positions, should the application be subject to significant thermal or vibration movement.

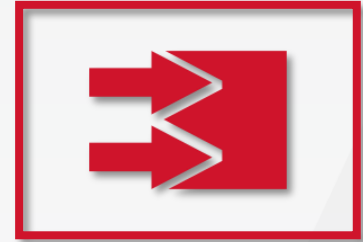

PRECAUTIONS & LIMITATIONS

- a. Install in moderate ambient conditions i.e. at temperatures between 10°C and 30°C and protect from excessive wind.
- b. Adhere to good health and safety practises – wear rubber gloves and goggles to protect hands and eyes.
- c. Keep adhesive away from children and pets. Do not ingest.
- d. Do not wash excess material into drains. Allow to harden and dispose with solid waste.



*This guideline only serves as a basic manual for the surface preparation, product selection and installation procedure for this type of application. Each installation needs to be assessed on merits and the products used and the procedures followed should be in accordance with the SABS code for the design and installation of ceramic tiles (SABS 10107:2011).